

AHL Type

90° 橫向銑頭

90° Angle Head

- 輕量化設計，適用於鑽銑加工及攻牙加工。
- 自動刀庫換刀加工，量化生產必備工具。
- 環抱型定位塊設計，可 360 度旋轉調整加工角度，並加強鎖固力道及加工角度精確性。

| | |
|-------|-----------------------|
| 內孔偏擺度 | 0.002 mm |
| 材質 | 航太用鋁合金 / 球狀石墨鑄鐵 / 合金鋼 |
| 轉速 | 最高 6000 RPM |
| 扭力 | 最大 30 Nm |
| 齒輪比 | 1 : 1 |
| 適用主軸 | BT, SK(ISO), CAT |
| 標準配件 | 開口扳手、ER 扳手、ER 螺帽 |
| 出力軸轉向 | 反轉 |

- Compact and lighter body design is suitable for drilling, milling, and tapping application.
- Can be automatic tool changed. Increases productivity.
- Enclosed Positioning Pin: Cutting Direction can be adjusted from 0~360 degrees. It allows higher clamping torque and cutting direction could remain during the machining.

| | |
|--------------------|--|
| Run-out | 0.002 mm |
| Material | Aerospace Alu. Alloy / Ductile Cast Iron / Alloy Steel |
| R.P.M. | Max. 6000 RPM |
| Torque | Max. 30 Nm |
| Gear Ratio | 1 : 1 |
| Spindle Type | BT, SK(ISO), CAT |
| Standard Accessory | Open End Wrench, ER Wrench, ER Nut |
| Output Rotation | Reverse to Input Rotation |

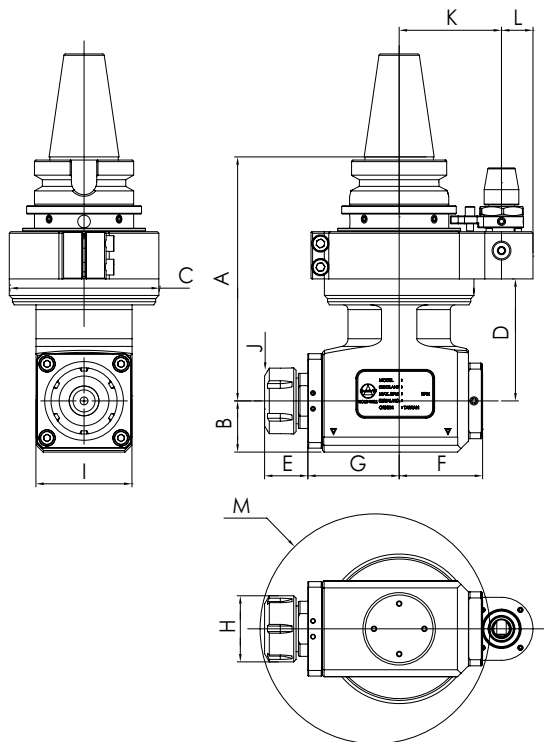

Unit : mm

| Model NO. | A | B | C | D | E | F | G | H | I | J | K | L | M | N.W.(KG) |
|------------------------|-------|------|----|------|------|----|----|----|----|-------------|-----------|----|-----|----------|
| AHL-BT40-A2.65/80/110 | 155 | 32.5 | 95 | 77.5 | 27.5 | 53 | 58 | 42 | 61 | 1~16 (ER25) | 65/80/110 | 20 | 146 | 6.7 |
| AHL-SK40-A2.65/80/110 | 160.5 | 32.5 | 95 | 77.5 | 27.5 | 53 | 58 | 42 | 61 | 1~16 (ER25) | 65/80/110 | 20 | 146 | 6.7 |
| AHL-CAT40-A2.65/80/110 | 160.5 | 32.5 | 95 | 77.5 | 27.5 | 53 | 58 | 42 | 61 | 1~16 (ER25) | 65/80/110 | 20 | 146 | 6.7 |
| AHL-BT50-A2.80/110 | 162 | 32.5 | 95 | 77.5 | 27.5 | 53 | 58 | 42 | 61 | 1~16 (ER25) | 80/110 | 20 | 146 | 9.1 |
| AHL-SK50-A2.80/110 | 162 | 32.5 | 95 | 77.5 | 27.5 | 53 | 58 | 42 | 61 | 1~16 (ER25) | 80/110 | 20 | 146 | 9.1 |
| AHL-CAT50-A2.80/110 | 162 | 32.5 | 95 | 77.5 | 27.5 | 53 | 58 | 42 | 61 | 1~16 (ER25) | 80/110 | 20 | 146 | 9.1 |
| AHL-BT40-A3.65/80/110 | 155 | 32.5 | 95 | 77.5 | 32.5 | 53 | 58 | 50 | 61 | 3~20 (ER32) | 65/80/110 | 20 | 152 | 6.7 |
| AHL-SK40-A3.65/80/110 | 160.5 | 32.5 | 95 | 77.5 | 32.5 | 53 | 58 | 50 | 61 | 3~20 (ER32) | 65/80/110 | 20 | 152 | 6.7 |
| AHL-CAT40-A3.65/80/110 | 160.5 | 32.5 | 95 | 77.5 | 32.5 | 53 | 58 | 50 | 61 | 3~20 (ER32) | 65/80/110 | 20 | 152 | 6.7 |
| AHL-BT50-A3.80/110 | 162 | 32.5 | 95 | 77.5 | 32.5 | 53 | 58 | 50 | 61 | 3~20 (ER32) | 80/110 | 20 | 152 | 9.1 |
| AHL-SK50-A3.80/110 | 162 | 32.5 | 95 | 77.5 | 32.5 | 53 | 58 | 50 | 61 | 3~20 (ER32) | 80/110 | 20 | 152 | 9.1 |
| AHL-CAT50-A3.80/110 | 162 | 32.5 | 95 | 77.5 | 32.5 | 53 | 58 | 50 | 61 | 3~20 (ER32) | 80/110 | 20 | 152 | 9.1 |

AHL-A2/A3